

# Air diverter

Air diverter

AT 8060B

Art. No.	R S K	Application	Performance	Body material	Sealing material	DN	PN	Temperature (°C)	Connection
		F	F	F,R		R	R	R	F,R
80 60 B1 5		Air separation water; air separation glycol	Automatic venting	Brass		1 5	1 0	0-110	External thread
80 60 B H 15		Air separation water; air separation glycol	Automatic venting	Brass		1 5	1 0	0-180	External thread
80 60 SS H 15		Air separation water; air separation glycol	Automatic venting	Stainless acid-proof steel		1 5	1 0	0-180	External thread

Dimension range	PN	Temperature range	Material
DN 15	10	0 °C to 110 °C	Brass

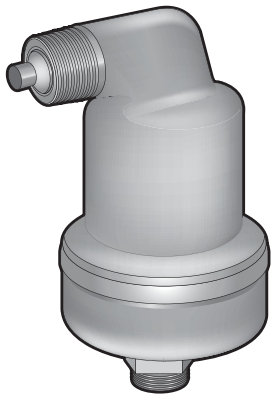

AT 8060B

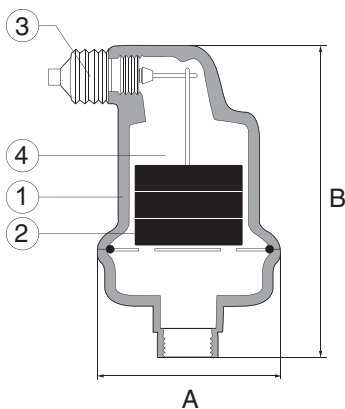

For automatic air separation of heating and cooling systems where the fluid is water or glycol. Can be mounted in systems with a mix of water/glycol and water/ethanol, if control and oversight is increased. The valve should not be used in systems with a mix of water/salts.

### Program text

PSF.1412 Automatic air separator

Automatic air separator AT8050B15, brass, PN10, with a large air chamber and dirt protection. Provided with a shut-off valve AT 3640-15.

### Quality assurance

Fulfills AFS 1994:4 §8 standards and should not be CE-marked. All extractors are tightness tested.

### Details

- |   |   |
|---|---|
| 1 | Float chamber and top of brass  |
| 2 | Float of polypropylene, suspended in a bar<br>For safe communication with the separation mechanism                                |
| 3 | Unique valve mechanism in leak proof performance  |
| 4 | Air chamber with large volume for max. operation safety<br>Protects the valve mechanism against pollution and pressure variations |

### Dimensions and weight

Connection	G ½
A	121
B	65
Vikt	0,7

Internal thread

### Function and design

The releasing valve has a high resistance to contamination and maintenance costs can be minimized since large air bubbles are continuously removed both quickly and automatically.

When air enters the float body, the liquid level sinks and the float drops. When the float, that is connected to the separation mechanism via a bar, reaches a certain level, the mechanism is affected and air can flow out in the free. When the float rises again, the mechanism closes.

The large volume of the air chamber and special design makes the liquid level never reach the drainage mechanism, even if the air in the chamber is compressed to 10 bar.

### Technical information

An automatic air vent diverts only free gas bubbles. Gas that is dissolved in the fluid, due to high pressure and/or low temperature, can not be diverted. Can suck air in case of negative pressure. It will be a problem when system pressure is incorrect. But has an advantage in decomposing the system.

## Accessories and options

For hot water systems there is AT8060BH15 that can handle temperatures to 180°C. Also available in acid-proof steel with art. No. AT8060SSH15.

## Installing

Mounted in high spots or elsewhere that air can occur. For the right feature the arrestor needs to be mounted vertical with the connection downwards. Must be installed in places where the arrestor is available for inspection and possible cleaning. For access without interference, the AT3640 ball valve, with DN equal to the arrestor, is mounted as a shutdown.

## Maintenance and spare parts

The automatic air conditioner is basically maintenance free but should be checked and possibly cleaned periodically for safe operation.

## Marking

Marked with dimension, max. operation pressure, type number and manufacturer's name.

## How to order

### Example: AT 8060B15

Connection	AT-No.	Performance
G ½	8060B15	Brass, max 110 °C
G ½	8060BH15	Brass, max 180 °C
G ½	8060SSH15	Acid-proof steel, max 180 °C