

A-A (1:2)

HOLES FOR LIFTING

HOLES FOR LIFTING

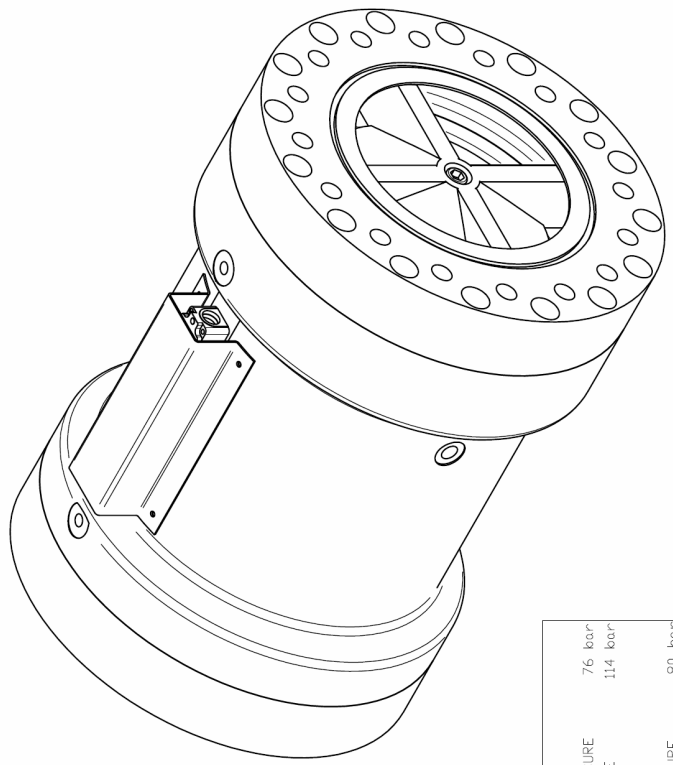
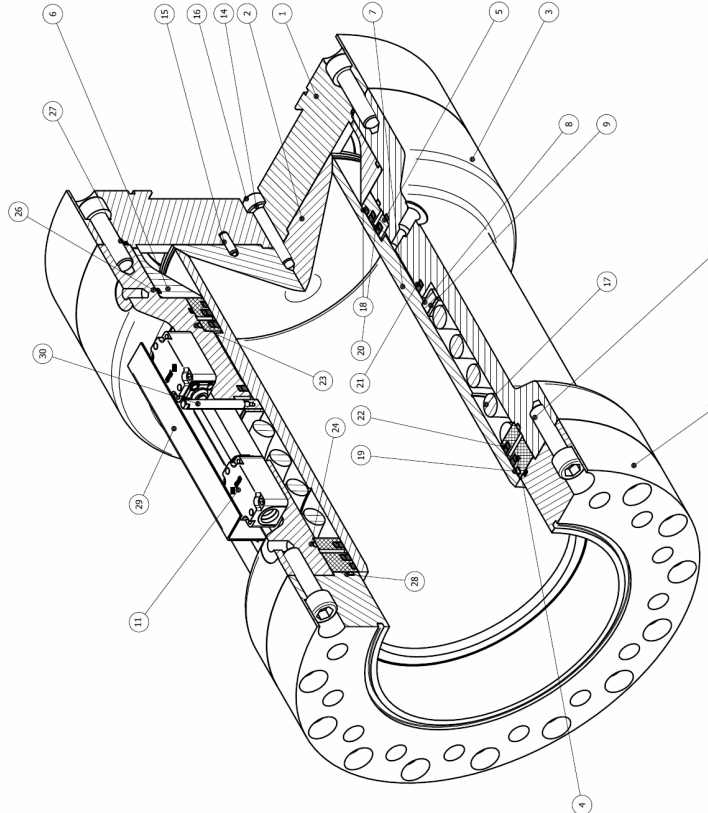
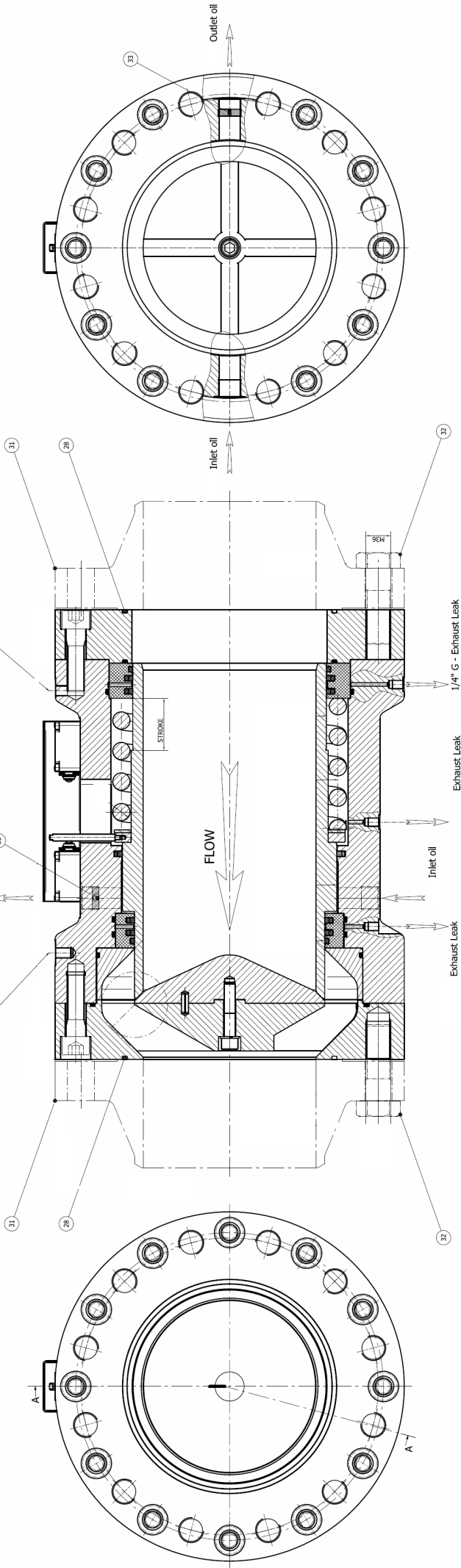

WATER SIDE:	76 bar
WORKING PRESSURE	114 bar
TEST PRESSURE	
OIL SIDE:	80 bar
MINIMUM PRESSURE	120 bar
WORKING PRESSURE	240 bar
TEST PRESSURE	

33	Oilfin	1
32	Screws TE M5x6 L10 UNI 7793	24
31	Flange ends	2
30	Prevention cover	1
28	OR-5,3 L=950 mm	1
27	OR-5,3 L=1240 mm	1
26	OR-5,3 L=1000 mm	1
25	OR-5,3 L=1050 mm	1
23	OR-5,3 L=1050 mm	2
22	Seal ITS-280 B04-BN	2
21	Seal ITS-310 B04-BN	3
20	Seal ITS-310 B04-BN	3
19	Scraper RD-280 B04-BN	1
18	Scraper RD-275 B04-BN	1
17	Sealing TEI M5x6x8 UNI 9591	1
16	Pin ex 10x30 UNI 6873	1
15	Pin ex 10x30 UNI 6873	1
14	Washer Gower M16 UNI 1751	1
13	Screws TEI M27x90 UNI 9591	23
12	Washer TEI 201	2
10	Rear Flange	2
9	Washer	1
8	Ring	1
6	Blush	1
5	Front bush	1
4	Rear bush	1
3	Wave body	1
2	Wave body	1
1	Front Cover	1

VALVE ASSEMBLY
WK-K-250/310/10-HP-FM
12832

Scale: 1:2
 Drawing No.: 12832
 Date: 12/12/2011
 Author: [Name]
 Checked: [Name]
 Approved: [Name]

Material: Cast Steel
 Surface Treatment: Paint
 Weight: 150 kg

Dimensions: 310 x 310 x 100 mm

Pressure Rating: 114 bar

Working Pressure: 76 bar (Water Side), 80 bar (Oil Side)
 Test Pressure: 120 bar (Water Side), 240 bar (Oil Side)