

Floating body gauge

AT 7730

Dimension range G 1/2	PN 20	Temperature range 5°C to +80°C	Material Stainless steel
---------------------------------	-----------------	--	------------------------------------

Range of application

Immediate measurement of the flow of air or water.

UGE.31 Flow gauge

Tube mounted with analog current flow indication.

Quality assurance

According to PED 2016:1

Material specification

1	Body	Stainless steel 1.4401
	Flow	
2	tube	Grilamid (PA-12)
3	Float	Stainless steel 1.4460 or 1.4460/PTFE depending on the measure area
	End	
4	piece	Nylon

Dimension and weight

A	53
B	202
C	34
D	134
E	38
Weight	ca 950g

Function and design

Float gauge in fluidised body-type for air or water. Measurement range in water 0.4 l / min to 30l / min and range in air 15NI / min to 700NI / min.

The instantaneous flow is read by the meter visually. The scale is adapted to the media. The flowmeter has an adjustment screw and is prepared for flow alarm.

Technical information

Adjustability	Adjusting screw
ambient temperature	0°C to +65°C
Media temperature	5°C to +85°C
Storage temperature	5°C to +65°C
Inaccuracy	±5%

Accessories and options

Flowmeters in other materials or for higher temperature on request.

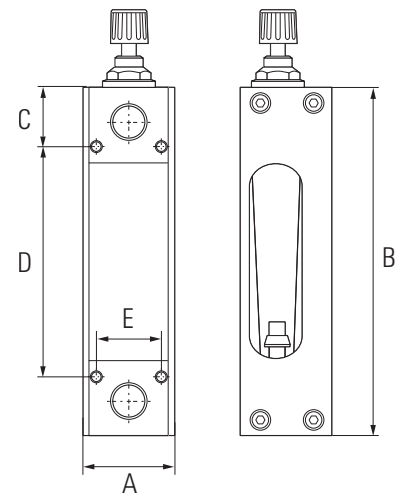

Installation

The flowmeter is installed in the flow direction horizontally.

Marking

The pressure sensor is labeled with the manufacturer's name, measuring range and serial number.

How to order

AT7730-3V		
AT 7730	3	V
Fig. no	Flow area (l/min)	V=Water L=Air

AT 4883	-1	-2,5	-6	-10	-16	-25	-40	-60	-100
Pressure range bar	0-1	0-2,5	0-6	0-10	0-16	0-25	0-40	0-60	0-100
Max. pressure bar	10	16	30	30	50	50	70	70	200

AT7730 Air	-70	-130	-170	-260	-300	-450	-650	-700
Range NI/min	15- 70	30- 130	40- 170	60- 260	75- 300	100- 450	100- 650	150- 700